

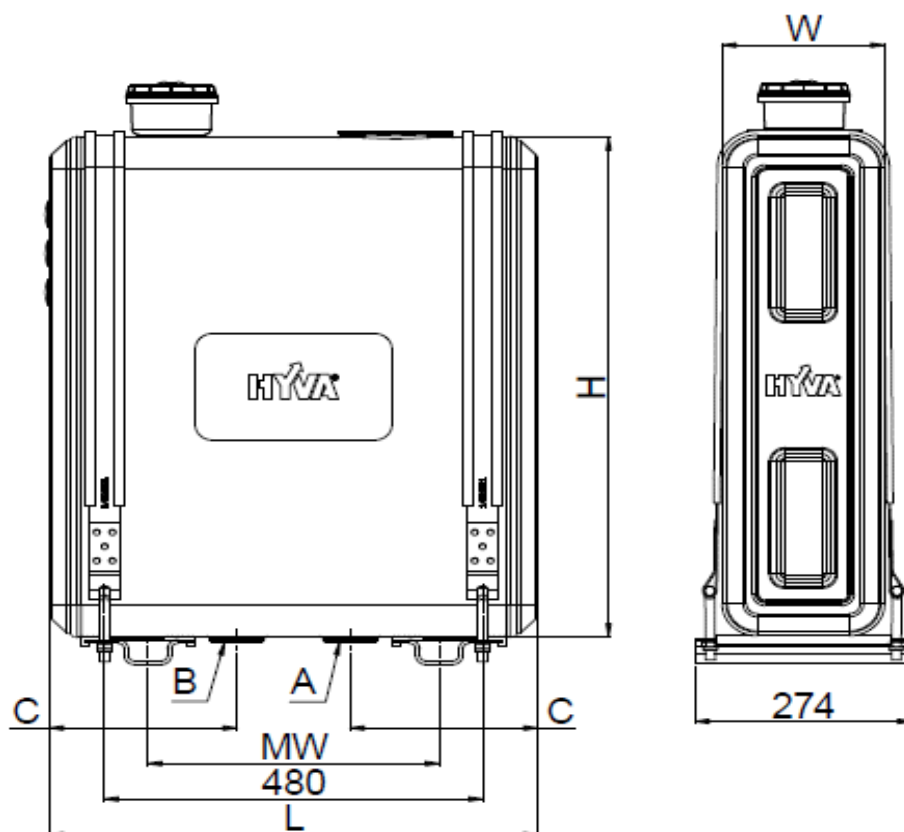

STEEL



ALUMINIUM



3D model is available on request

Specifications

Support Configuration.	Tank		
Part number	14015221	14015222	
*Air breather, strap, strap rubber & support rubber included with the tank	YES	YES	
Material	Steel	Aluminium	
W: Width	200	202	mm
H: Height	700	702	mm
L: Length	620	620	mm
MW : Mounting Width	370	370	mm
C : Distance to port	238	238	mm
Gross volume	81	80	litres
Working volume 1	65	65	litres
Working volume 2	59	58	litres
Working volume 3	52	52	litres
Weight of tank	26.2	13	kg
A: Suction port**	1"	1"	BSP
B: Suction port***	1 1/2"	1 1/2"	BSP

*Air breather included in tank packaging ; Return line filters must be ordered separately.

**The suction port (A) is closed with a permanent metal plug.

***The suction port (B) is closed with temporary plastic plug.

Technical notes

• Mount the tank according the mounting instructions • Fill the tank with the recommended hydraulic oil to the centre of the level indicator • Change the oil once a year • Replace the air breather and return filter element twice a year • Do not use the tank to stand on or as a support • Do not weld on the oil tank • Steel tank painted black (RAL9005) • Tank has a yellow (RAL1023) sticker.

Related documentation

Mounting instructions: OIL-0028

Oil specifications: OIL-0011

Mounting parts

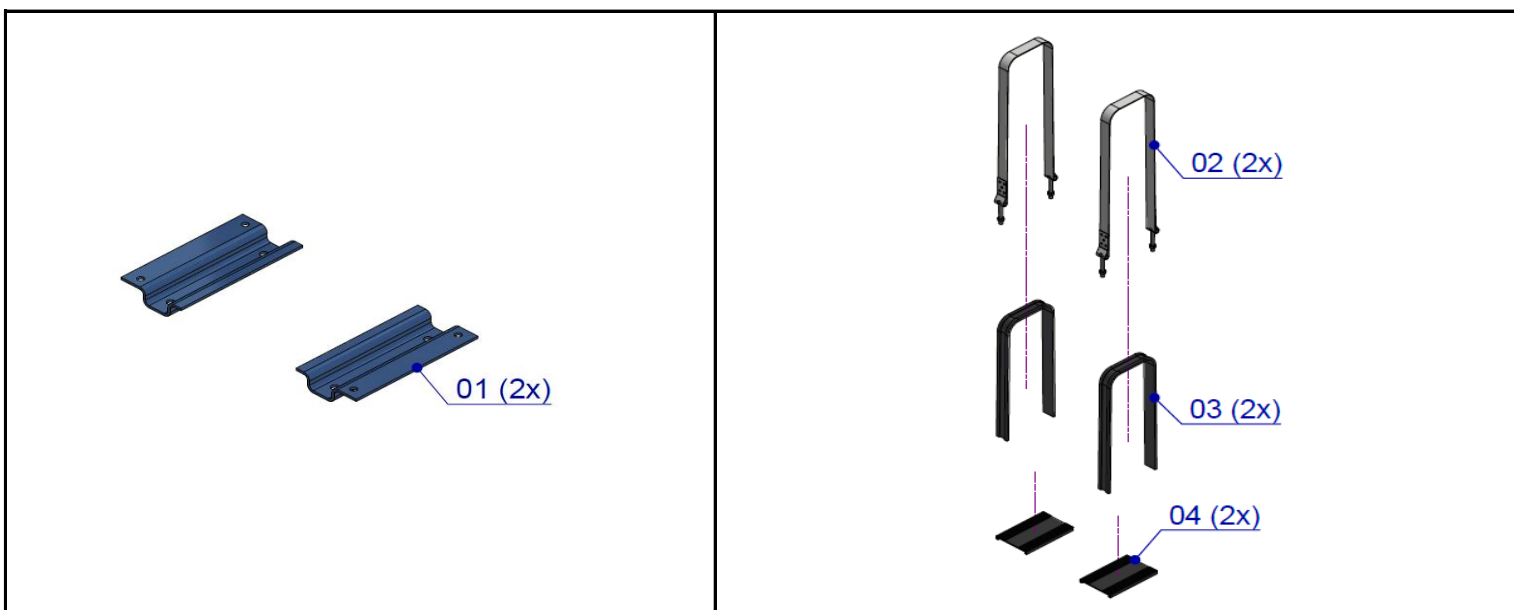

No.	Part no.	Description
01	14020523	RM Tank standard support kit*

* Full kit = 2 x (support brackets)

Attention! : Supports are not included in the tank.

To be ordered separately.

No.	Part no.	Description	Weight [kg]
02	14020521	Strap	1.0
03	14020335	Strap rubber	0.2
04	14221602	Support rubber	0.1

Number 02, 03 & 04 are included in the tank

Air breather



No.	Part no.	Description	Weight [kg]
05	08102116	Air breather	0.4

Attention! : Air breather included in the tank.

For Air breather spec. sheet, see DO-E 08102116

Accessories / Spare parts

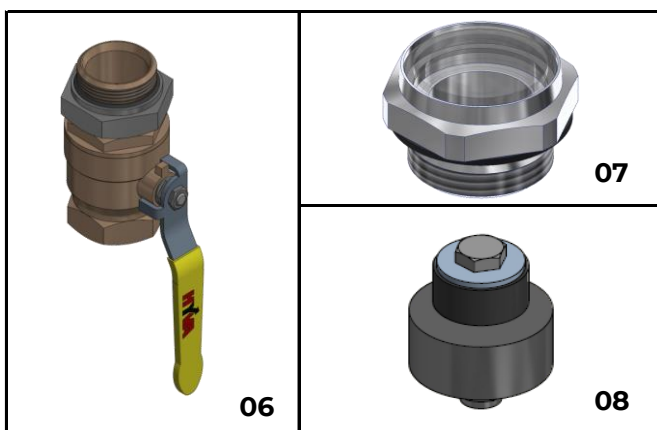

No.	Part no.	Description	Weight [kg]
06	14780981	Ball valve 1 1/2" BSP*	1.2
07	08102152	Aluminum spy eye 1" BSP (with gasket)**	0.041
08	08101078	Vibration Damper	0.2

*For more suction component see LPADAP01

**Attention! : Spy eye included in the Tank

Return filters

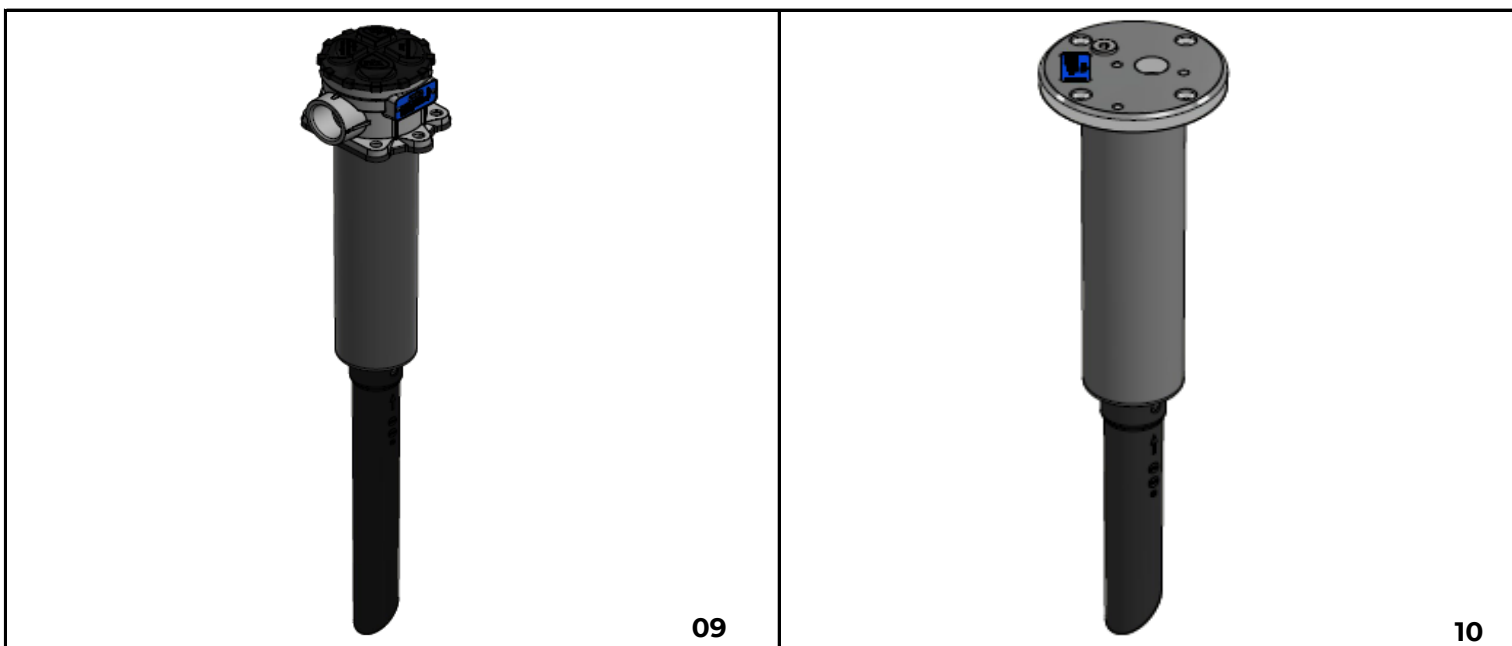

No.	Part no.	Description	Weight [kg]
09	14780353	Return filter housing type 250 L/m	1.4
10	14895925	Return filter plate type 250 L/m*	1.68

*Filter with mounting plate for tipping valve

Attention! : Return line filters are not in the tank. To be ordered separately.

For Return line filter spec. sheet, see RFILTE02

Option adaptor for plate filter

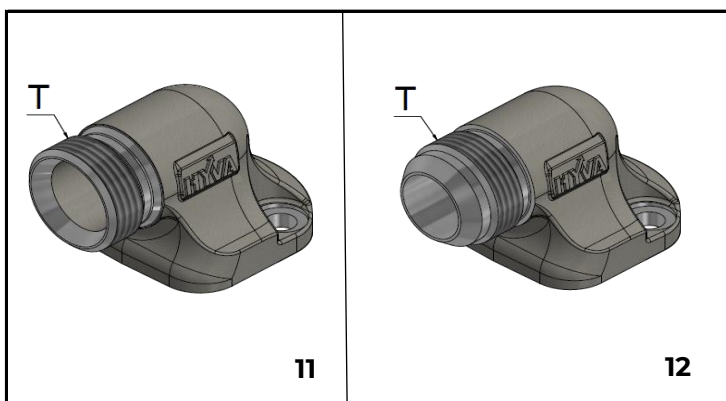

No.	Part no.	Description	Thread size (T)	Qty
11	01317987	Adaptor kit 90 for return filter	1" BSPOTC	1
12	01317988	Adaptor kit 90 for return filter	1" JICOTC	1

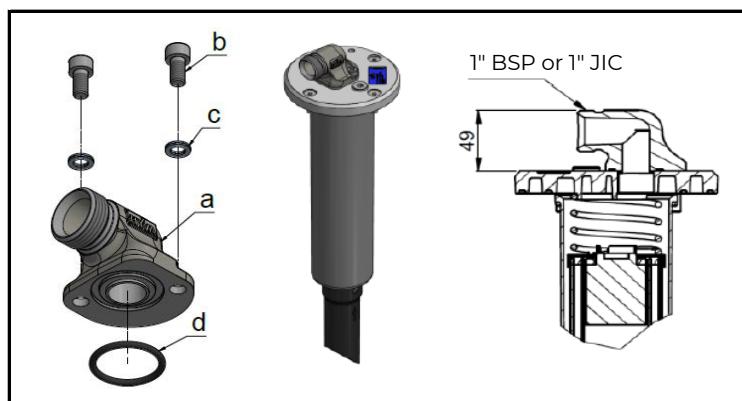

No.	Description	Qty
a	Adaptor-90-elbow-1" BSPOTC	1
	Adaptor-90-elbow-1" JICOTC	
b	Bolt HSHC M8x16x1.25 DIN 912 ZP	2
c	Nord-lock washer M8	2
d	O-Ring 34.60x2.62	1

Note : O-rings, bolts & washers are included with adapter

Valve mounting options

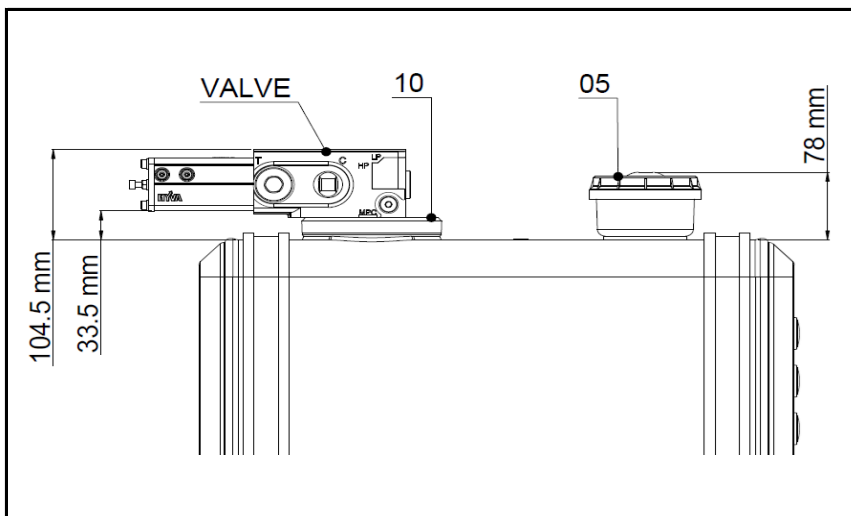

Valve mounted on top of tank

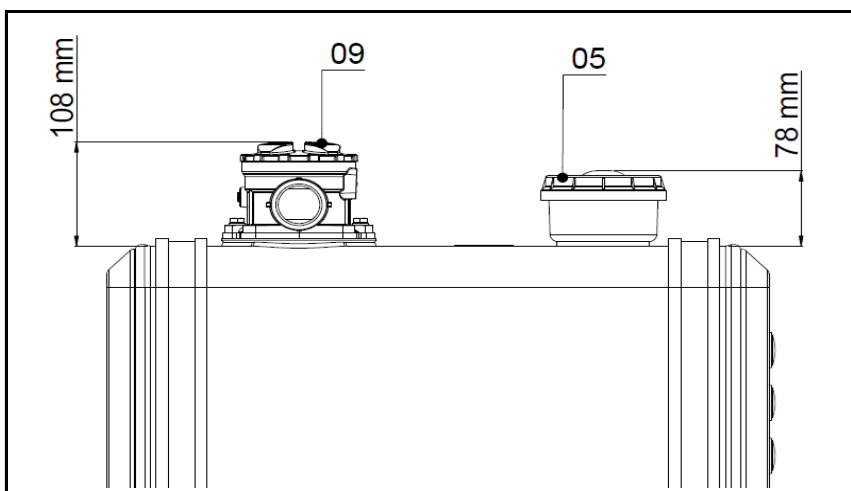

Valve mounted on chassis or cylinder (SAE)

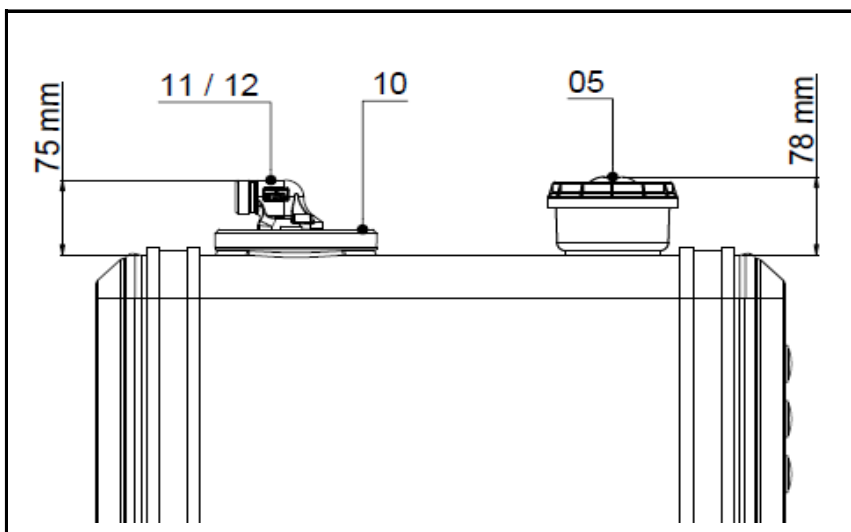

Valve mounted on chassis or cylinder with Return line Plate version