

- 1 Pump connection (P)
- 2 Tank connection (T)
- 3 Cylinder connection SAE(C)
- 4 Pneumatic connection (Tip)
- 5 Pneumatic connection (Lower)
- 6 pressure cartridge
- 7 Pressure gauge point
- 8 Adjustment screw
(To adjust the lowering speed)

SAFETY
HT valve fitted on cylinder (SAE)
Port offers hose burst safety function

For mounting on

- Directly on Hyva cylinder with SAE inlet

3D model is available on request

Types

Hydraulic connections	Pressure (BAR)	Part Number	Description
	Max.		
P = 3/4" & T=1" C = SAE	150	14767454	TIP VALVE HT-SAE-1220-150-P3/4"
	170	14767456	TIP VALVE HT-SAE-1220-170-P3/4"
	190	14767458	TIP VALVE HT-SAE-1220-190-P3/4"
	220	14767460	TIP VALVE HT-SAE-1220-220-P3/4"
	250	14767462	TIP VALVE HT-SAE-1220-250-P3/4"
T & P=1" C = SAE	150	14767455	TIP VALVE HT-SAE-1220-150-P1"
	170	14767457	TIP VALVE HT-SAE-1220-170-P1"
	190	14767459	TIP VALVE HT-SAE-1220-190-P1"
	220	14767461	TIP VALVE HT-SAE-1220-220-P1"
	250	14767463	TIP VALVE HT-SAE-1220-250-P1"

Optional adapter kits	Kit number
3/4" Straight SAE	AK5112SS
3/4" 90 degree SAE	AK5112SE
1" Straight SAE	AK5116SS
1" 90 degree SAE	AK5116SE

Mounting kits	Kit number
Cylinder (SAE)*	14735175

* = included with valve

Specifications

Type	Spool valve with pressureless bypass in neutral. Oil flow in lowering position is proportional with pneumatic pilot pressure	
Max. peak pressure	300 bar	
Pneumatic pilot pressure	6-12 bar	
Max. pump flow	220 L/min	
Max. pressure on T-connection	10 bar	
Min. filtration (ISO 18/13)	25 µm	
Viscosity range	min	12 mm ² /s (cst)
	max	100 mm ² /s (cst)
Temperature range	min	-40 °C
	max	80 °C
Mass	5,5 kg	

Δp - Q characteristic

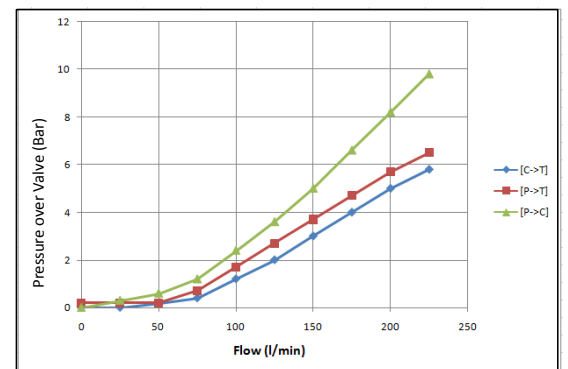

Technical notes

- Mount the valve according the mounting instructions
- Use the correct washers and adapters in the ports to prevent housing deformation. Do not use adapters with tapered threads
- To further prevent deformation of the valve housing, the mounting plate surface or block must be completely flat and plane.
- Do not weld to the valve.
- Ideal air pressure for valve is 8 bar.
- Make sure inlet air is dry.
- Paint spec: TNO00_00001

Related documentation

Mounting instructions: VAL-0021

OIL Specifications: OIL:0011

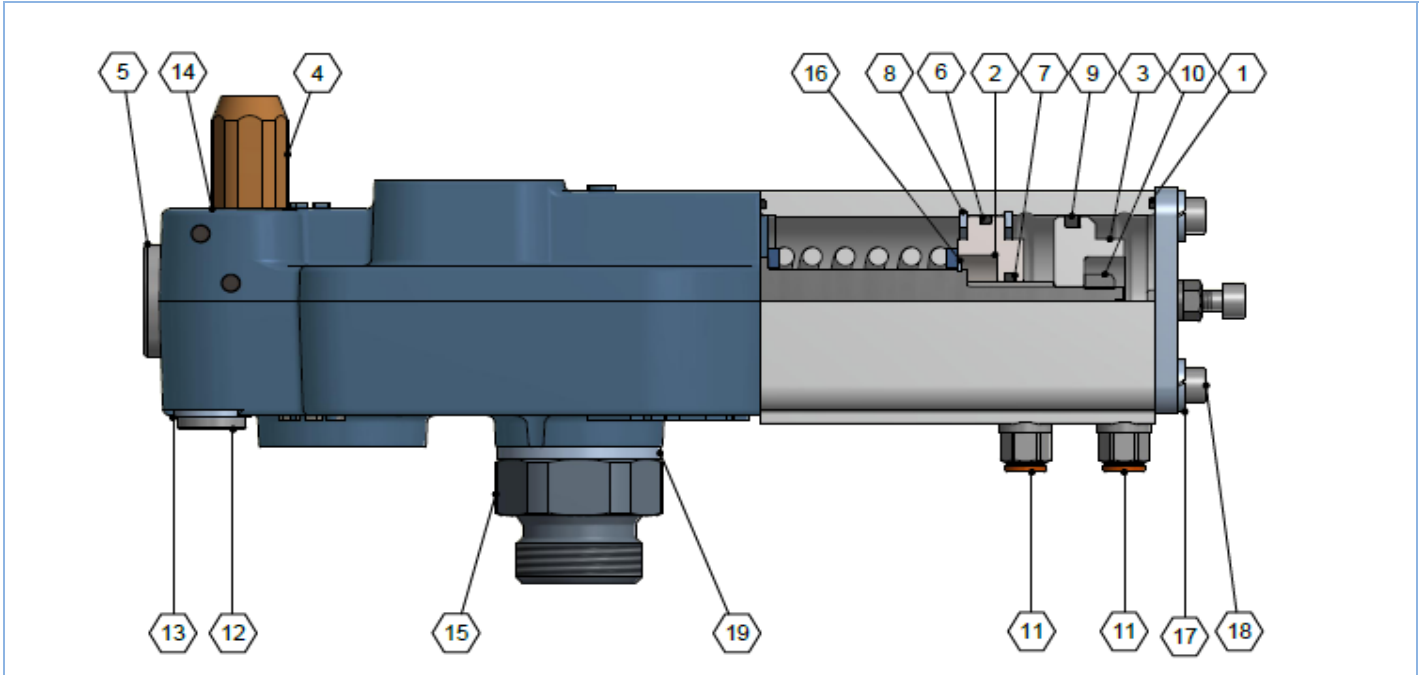

Spare Parts

No.	Part no.	Description	Qty
1	01226200	o-ring	2
2	14845005	closing plate	1
3	14845007	piston air cylinder	1
4	14772...	cartridge pressure relief	1
	14772150	150 bar	
	14772170	170 bar	
	14772190	190 bar	
	14772220	220 bar	
	14772250	250 bar	
5	14845024	blind plug	1
6	14845013	O-ring	1

No.	Part no.	Description	Qty
7	14845018	quadring	1
8	14845019	circlip	2
9	14845020	quadring	1
10	14845015	sealing nut M8 for HT-valve	1
11	14810517	air coupling 1/8"	2
12	14845039	blind plug	1
13	01206813	bonded seal	1
14	14841215	o-ring 10,82 x 1,78	1
15	14739980	non return valve 3/4"	1
15	14739975A	non return valve 1"	1
16	15029046	circlip	1
17	15022015	washer spring	4
18	15013639	bolt HSHC	4
19	01313848	bonded seal	1

Hydraulic symbol of the HT valve

